

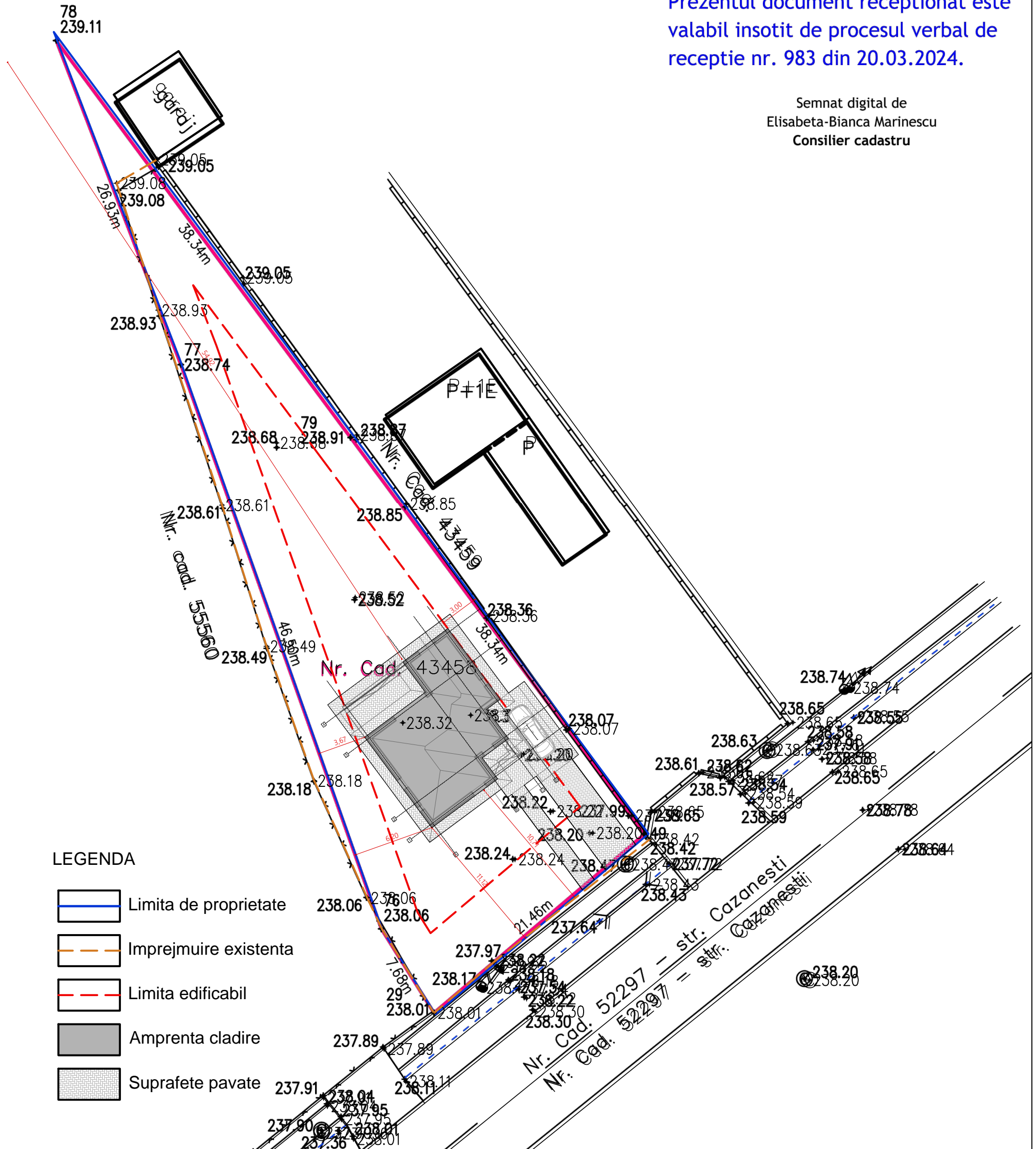



O.C.P.I. Vâlcea

Prezentul document receptionat este valabil insotit de procesul verbal de receptie nr. 983 din 20.03.2024.

Semnat digital de
Elisabeta-Bianca Marinescu
Consilier cadastru

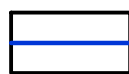

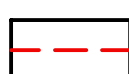
LEGENDA

-  Limita de proprietate
-  Imprejmuire existenta
-  Limita edificabil
-  Amprenta cladire
-  Suprafete pavate

INDICATORI URBANISTICI		Regim de inaltime: P		
S teren = 864 mp		Inaltime maxima la cornisa = 3,55 m		
S construita la sol = 132,4mp		Suprafata spatiu verde plantat = 659 mp		
S desfasurata = 132,4mp		Suprafata alei circulatii/platforme = 116 mp		
POT = 15,3%		CAT. DE IMPORTANTA "D"		
CUT = 0.15		CLASA DE IMPORTANTA IV		
PROIECTANT GENERAL:	BENEFICIAR:		PROIECT NR: A10/2023	
PROIECTANT ARHITECTURA:	TITLU PROIECT:		FAZA: D.T.A.C.	
SEF PROIECT:	Scara: 1:300	CONSTRUIRE LOCUINTAU UNIFAMILIALA PARTER SI IMPREJMUIRE Str. Cazanesti, nr. 82A, Mun. Ramnicu Valcea, jud. Valcea		
PROIECTAT:	Data: 02/2024	TITLU PLANSA:		PLANSA NR: 03
DESENAT:		PLAN DE SITUATIE		